

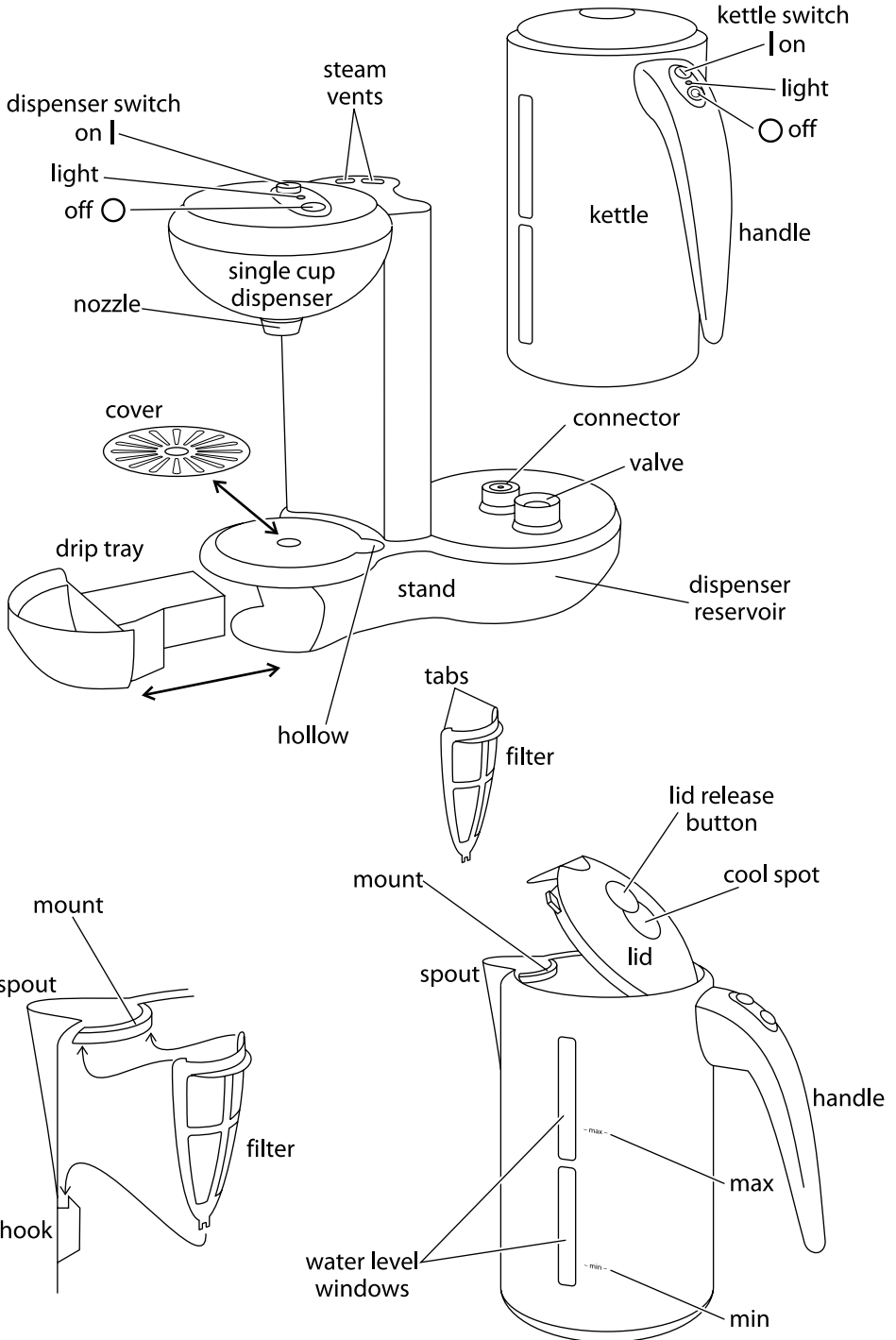

# Russell Hobbs



instructions



Read the instructions, keep them safe, pass them on if you pass the appliance on. Remove all packaging, but keep it in case you ever need to return the appliance.

## **important safeguards**

Follow basic safety precautions, including:

- 1 This appliance must only be used by or under the supervision of a responsible adult. Use and store it out of reach of children.
- 2 Don't put the kettle, stand, cable, or plug in liquid. Don't use the kettle in a bathroom, near water, or outdoors. 
- 3 The scald hazard lasts long after boiling. Keep the kettle, stand, and cable away from the edges of worktops and out of reach of children.
- 4 Route the cable so it doesn't overhang, and can't be tripped over or caught.
- 5 Don't touch hot surfaces (kettle body, lid, stand).
- 6 Don't open the lid while the water is heating.
- 7 Don't remove the kettle from the stand while the dispenser is operating.
- 8 Take care when pouring – pour slowly, and don't over-tilt the kettle.
- 9 Don't switch the dispenser on without filling the kettle at least to the **min** mark.
- 10 Don't switch the kettle on unless it's full to at least the **min** mark, **after the dispenser reservoir has filled itself.**
- 11 Don't fill the kettle past the **max** mark, or it may spit boiling water.
- 12 Remove the kettle from the stand before filling or pouring.
- 13 Unplug the stand when not in use, before moving and before cleaning. Let the kettle cool down before cleaning and storing away.
- 14 Check the lid is fully closed before switching the kettle on, or it may not switch off.
- 15 Keep the kettle, stand, cable, and plug away from sources of heat.
- 16 Don't use the appliance for any purpose other than heating water.
- 17 Use the kettle only with the stand supplied (and vice versa).
- 18 This appliance must not be operated by an external timer or remote control system.
- 19 Don't use the appliance if it's damaged or malfunctions.
- 20 If the cable is damaged, return the appliance, to avoid hazard.

## **household use only**

### **before using for the first time**

- 1 Fill the kettle to the **max** mark.
- 2 Boil the kettle.
- 3 When the kettle has boiled, sit a 240ml cup on the cover, under the nozzle, and switch the dispenser on.
- 4 Wait till the kettle and dispenser have cooled.
- 5 Discard the water in the kettle and cup.
- 6 Rinse the kettle.

### **positioning**

- 7 Put the stand on a stable, level surface.
- 8 Route the cable so it doesn't overhang, and can't be caught or tripped over.
- 9 Wind excess cable beneath the stand.

## filling the kettle

**caution** keep clear, steam may escape from the lid

- 10 Remove the kettle from the stand.
- 11 Press the lid release button to open the lid.
- 12 Put fresh water into the kettle
  - a) fill it at least to the **min** mark
  - b) don't fill it above the **max** mark
- 13 If you overfill, the kettle may spit boiling water.
- 14 Close the lid, and press on the cool spot, to lock it closed.
- 15 Check the lid is closed, or the kettle won't switch off when it boils.

## filling the dispenser

- 16 When you put the kettle on the stand, if the dispenser is empty, the valve opens, and 240 millilitres (8½floz) of water goes from the kettle into the dispenser.
- 17 You'll see the water level in the windows go down.
- ★ If you really need a full kettle of water (1.7 litres), wait till the water level has stabilised, then remove the kettle and top it up to the **max** mark.

## power up

- 18 Put the kettle on the stand – it only fits one way.
- 19 Check that the kettle and dispenser switches are off – press  on both switches.
- 20 Check that the drip tray is in place and empty.
- 21 Plug the stand into a power socket (switch the socket on, if it's switchable).

## single cup? – use the dispenser

- 22 Check there's enough water in the kettle (**min**) for the dispenser reservoir to refill.
- ★ Use a cup with a handle, and a capacity of at least 240 millilitres.
- 23 Sit the cup on the cover, and centre it under the nozzle.
- 24 Press | on the dispenser switch – the light on the switch glows, the water in the dispenser reservoir heats up.
- 25 When the water boils, it pours from the nozzle into the cup, the dispenser switches itself off, and the light goes out.
- 26 To switch off manually, move the dispenser switch to .

**caution** keep clear of steam coming from the steam vents

## multi-cup? – use the kettle

- 27 Check there's enough water in the kettle for your needs.
- 28 Press | on the kettle switch – the light on the switch glows, the kettle heats up.
- 29 When the water boils, the kettle switches off, and the light goes out.
- 30 To switch off manually, move the kettle switch to .

## pouring

- 31 Remove the kettle from the stand before pouring.
- 32 To avoid the risk of splashing, pour slowly and don't over-tilt the kettle.
- 33 Don't tilt the kettle backwards – water might get on to the control area.
- 34 If this happens, let the kettle dry before use – sit it somewhere warm for 12 hours.

## **single cup – again?**

- 35 You used the dispenser instead of the kettle, now you want another single cup?
- 36 No problem – wait till the reservoir refills (3 seconds if the kettle's cold, 15 seconds if it's hot).
- 37 Go back to point 22 on the opposite page.

## **general**

- 38 When you lift the kettle, you may see moisture on the stand. Don't worry – it's the steam used to switch the kettle off automatically, which then condenses and escapes via vents under the kettle.
- 39 Don't worry about discolouration on the floor of the kettle. It's due to the bonding of the element to the kettle floor.
- 40 Don't try to boil the kettle and the dispenser at the same time. Using both elements would overload the power socket, so we've interlocked the switches, so if you do this accidentally, the dispenser will override the kettle.
- 41 If you leave the dispenser unused for a few days, fill the kettle with fresh water, boil off the water in the dispenser reservoir into a 240ml cup, and pour it away, as the water will be stale. The stale water won't do you any harm, as it'll have been boiled by the time it reaches the cup, but it'll probably affect the taste of your drink.

## **using with insufficient water**

- 42 This will shorten the life of the elements.
- 43 A boil-dry cut-out will switch the element off.
- 44 To prevent it cycling on and off, unplug the stand (switch the socket off first, if it's switchable), and leave it till it gets cold.
- 45 Don't fill the kettle till it's cold, or it may spit.

## **care and maintenance**

- 1 Check that the kettle and dispenser switches are off – press  on both switches.
- 2 Unplug the stand (switch the socket off first, if it's switchable), and let the kettle and stand cool down fully.
- 3 Remove the kettle from the stand, wipe it, inside and out, with a damp cloth. You may use a little household detergent, but if you do, rinse well to avoid tainting the water.
- 4 Put a finger in the hollow by the side of the cover, lift the cover off, and wipe it with a damp cloth.
- 5 Pull the drip tray gently out of the stand, empty it, then wipe it, inside and out, with a damp cloth.
- 6 Wipe the surfaces of the stand with a damp cloth.
- 7 Replace the drip tray, the cover, then the kettle on the stand.
- 8 Keep all connectors and sockets dry.
- 9 Don't put the kettle or stand in liquid.
- 10 Don't use harsh or abrasive cleaning agents or solvents.
- 11 Don't put any part of the appliance in a dishwasher.

## **water filter**

- 12 Scale particles suspended in the water may give it a cloudy or greasy appearance. The filter will prevent these particles going from the kettle into your drink. If you see deposits on the filter, clean it, otherwise the performance of your kettle will drop, your drinks may contain scale, and the water inside the kettle may look cloudy.

## **cleaning the filter**

- 13 Check your hands are free from soap, hand cream, or anything that might leave a taint.
- 14 Switch the kettle off, and let it cool.
- 15 Open the lid.
- 16 Push the top of the filter down and back, into the kettle, to release the tabs on the top of the filter from the mount behind the spout, then lift the filter out of the kettle.
- 17 Rinse the filter under a running tap while brushing with a soft brush.
- 18 Rinse the kettle, in case scale particles have fallen inside.
- 19 Lower the filter into the kettle, and engage the bottom of the filter in the hook below the spout.
- 20 Press the filter forward, towards the spout, to force the tabs on the top of the filter under the mount behind the spout.
- 21 Close and lock the lid.

## **descale regularly – even in soft water areas**

- 22 Limescale may be white, coloured, even rusty-looking, but it's normally visible on the walls or floor of the kettle.
- 23 Phosphate scale isn't generally visible, but it's there, even in soft water areas.
- 24 All scale causes overheating, reduces the life of the elements, and may trigger the boil-dry cut-out.
- 25 So, even with soft water, descale regularly, to help keep the kettle in working order.
- 26 Use a descaler suitable for plastic products (all kettles have plastic parts).
- 27 Follow the instructions provided with the descaler regarding ventilation of the room, as some descalers are a bit smelly.

## **procedure**

- 28 Because of the dispenser, descaling is a bit different to what you're used to.
- 29 Fill the kettle, put it on the stand, and boil it.
- 30 Add the descaler to the kettle.
- 31 Sit a 240ml cup on the cover, and switch the dispenser on – this will move the fresh water out of the dispenser reservoir, and fill it with descaler.
- 32 Empty the cup, and replace it on the cover.
- 33 Leave the descaler to work for however long is recommended in the descaler instructions.
- 34 Empty the kettle, rinse it three times, then fill it to **max** with fresh water.
- 35 Operate the dispenser three times – this will flush the descaler out, then rinse the dispenser reservoir.
- 36 Fill the kettle again, and you're ready for normal use.
- ✳ Products returned under guarantee with faults due to scale will be subject to a repair charge.



## connection

The product must be earthed. It has a 13A BS1362 fuse in a 13A BS1363 plug. To replace the plug, fit the green/yellow wire to ⊕ or E, the blue wire to N, and the brown wire to L. Fit the cord grip. If in doubt, call an electrician. Don't use a non-rewireable plug unless the fuse cover is in place. If you remove the plug, dispose of it.

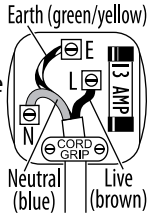

## wheelie bin symbol

To avoid environmental and health problems due to hazardous substances in electrical and electronic goods, appliances marked with this symbol mustn't be disposed of with unsorted municipal waste, but recovered, reused, or recycled.



## service

If you ring Customer Service, please have the **Model No.** to hand, as we won't be able to help you without it. It's on the rating plate (usually underneath the product).

The product isn't user-serviceable. If it's not working, read the instructions, check the plug fuse and main fuse/circuit breaker. If it's still not working, consult your retailer.

If that doesn't solve the problem – ring Customer Service – they may be able to offer technical advice.

If they advise you to return the product to us, pack it carefully, include a note with your name, address, day phone number, and what's wrong. If under guarantee, say where and when purchased, and include proof of purchase (till receipt). Send it to:

**Customer Service, Salton Europe Ltd, Failsworth, Manchester M35 0HS**

email: [service@saltoneurope.com](mailto:service@saltoneurope.com)

telephone: 0845 658 9700 (local rate number)

## guarantee

Defects affecting product functionality appearing within one year of purchase will be corrected by replacement or repair provided the product is used and maintained in accordance with the instructions. Your statutory rights are not affected.

Documentation, packaging, and product specifications may change without notice.

## online

[www.russellhobbs.co.uk](http://www.russellhobbs.co.uk) for more products